

⚠ WARNINGS

Before assembling this sim racing cockpit, please read all installation instructions and warnings thoroughly.

FAILURE TO COMPLY WITH ALL ASSEMBLY, SAFETY, AND OPERATION INSTRUCTIONS AND WARNINGS WHEN USING THIS PRODUCT MAY RESULT IN SERIOUS INJURY.

This sim racing cockpit meets all safety regulations. Improper use may result in injury to individuals and damage to the chassis.

RSEAT EVO

INSTRUCTION MANUAL

revision 01 / 12.2025

BUTTONBOX Mount

EVO BUTTONBOX MOUNT - ASSEMBLY



No.6 Hex Key



B3 M8x20
DIN 912



N2 M8 NUT
DIN 6923

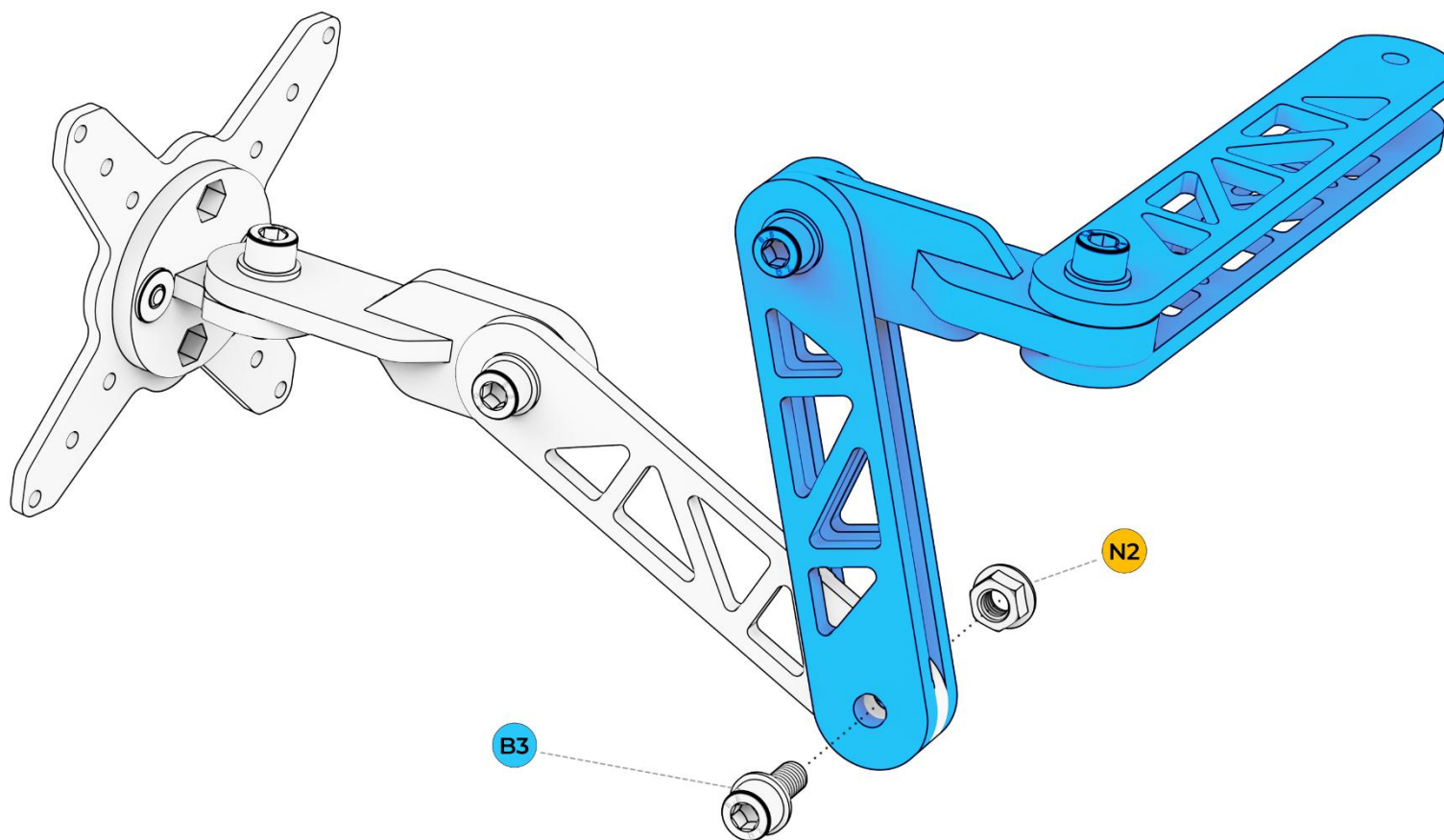

EVO BUTTONBOX MOUNT - INSTALLATION ON LEFT/RIGHT SIDE OF CHASSIS



No.6 Hex Key



B15 M8x25
DIN 912



N2 M8 NUT
DIN 6923

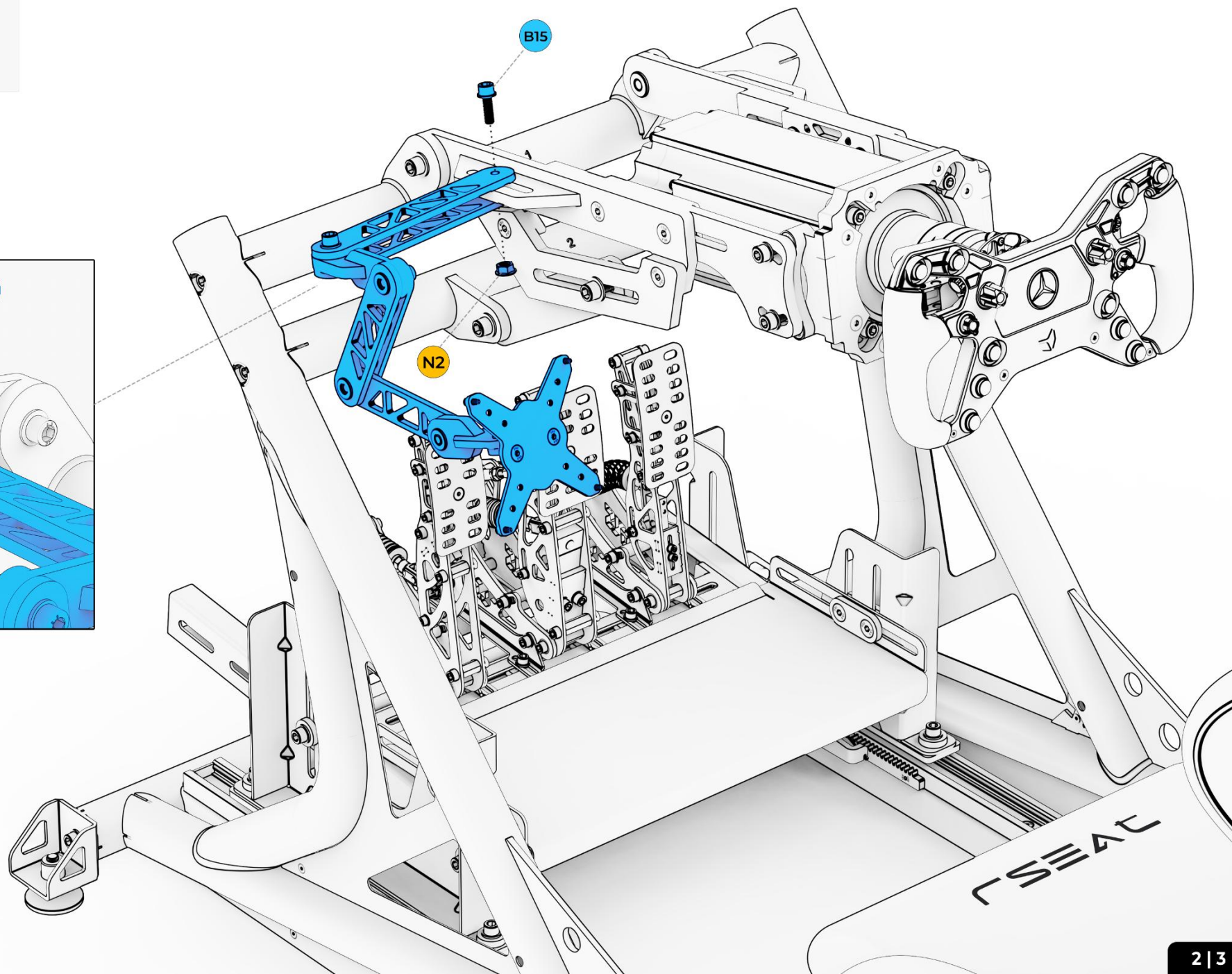
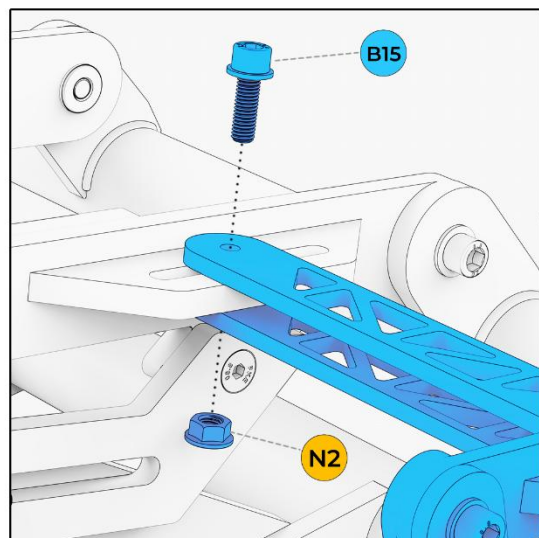

EVO BUTTONBOX MOUNT - INSTALLATION



No.3 Hex Key



M4x16
DIN 912

Attach the Buttonbox to the appropriate VESA mounting bracket (75x75 or 100x100) using the supplied M4x16mm bolts and a No. 3 hex key.

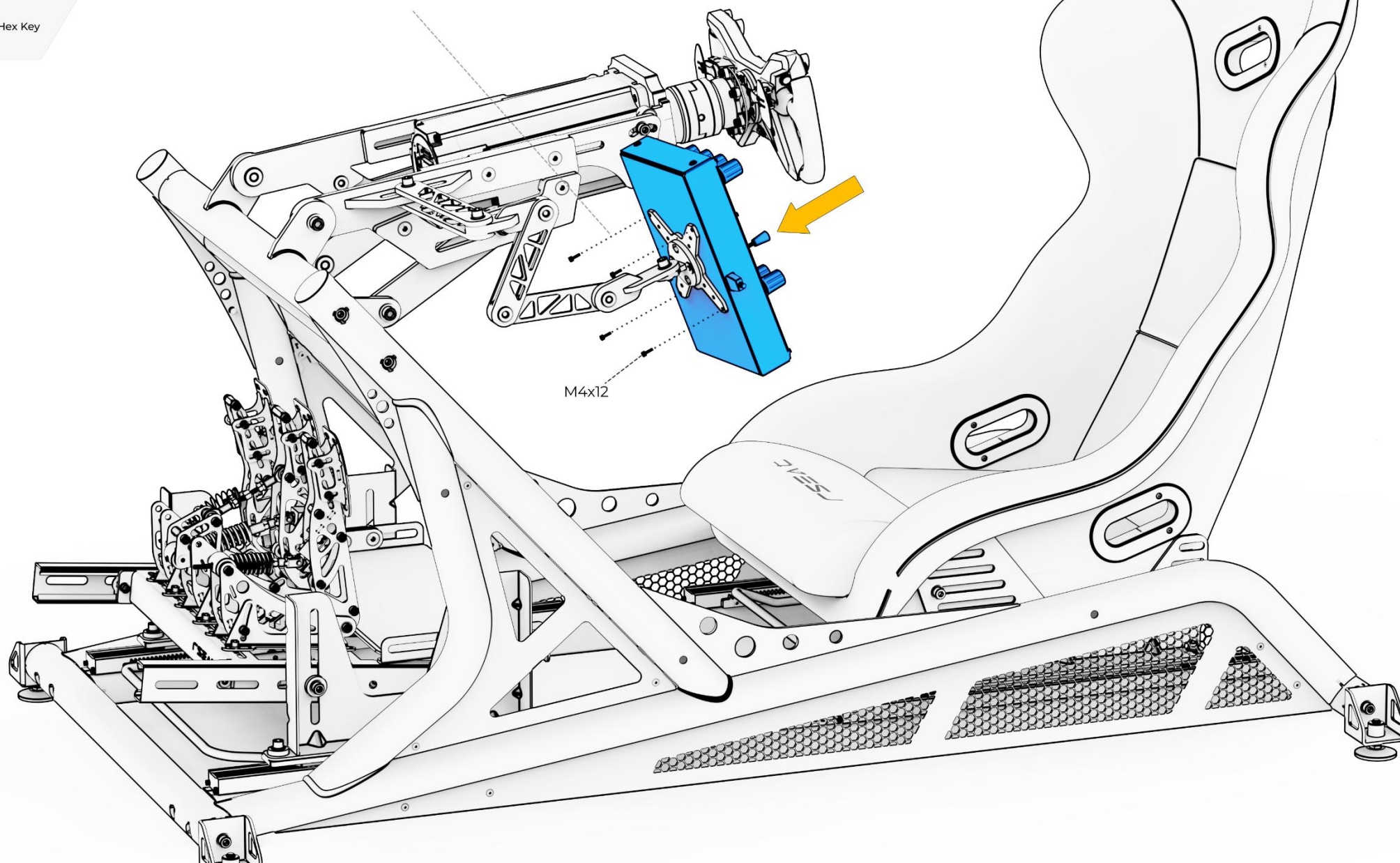

M4x12