

⚠ WARNINGS

Before assembling this sim racing cockpit, please read all installation instructions and warnings thoroughly.

FAILURE TO COMPLY WITH ALL ASSEMBLY, SAFETY, AND OPERATION INSTRUCTIONS AND WARNINGS WHEN USING THIS PRODUCT MAY RESULT IN SERIOUS INJURY.

This sim racing cockpit meets all safety regulations. Improper use may result in injury to individuals and damage to the chassis.

RSEAT EVO

INSTRUCTION MANUAL

revision 01 / 12.2025

Keyboard / Mouse Tray

EVO KEYBOARD TRAY - LEFT-SIDE INSTALLATION

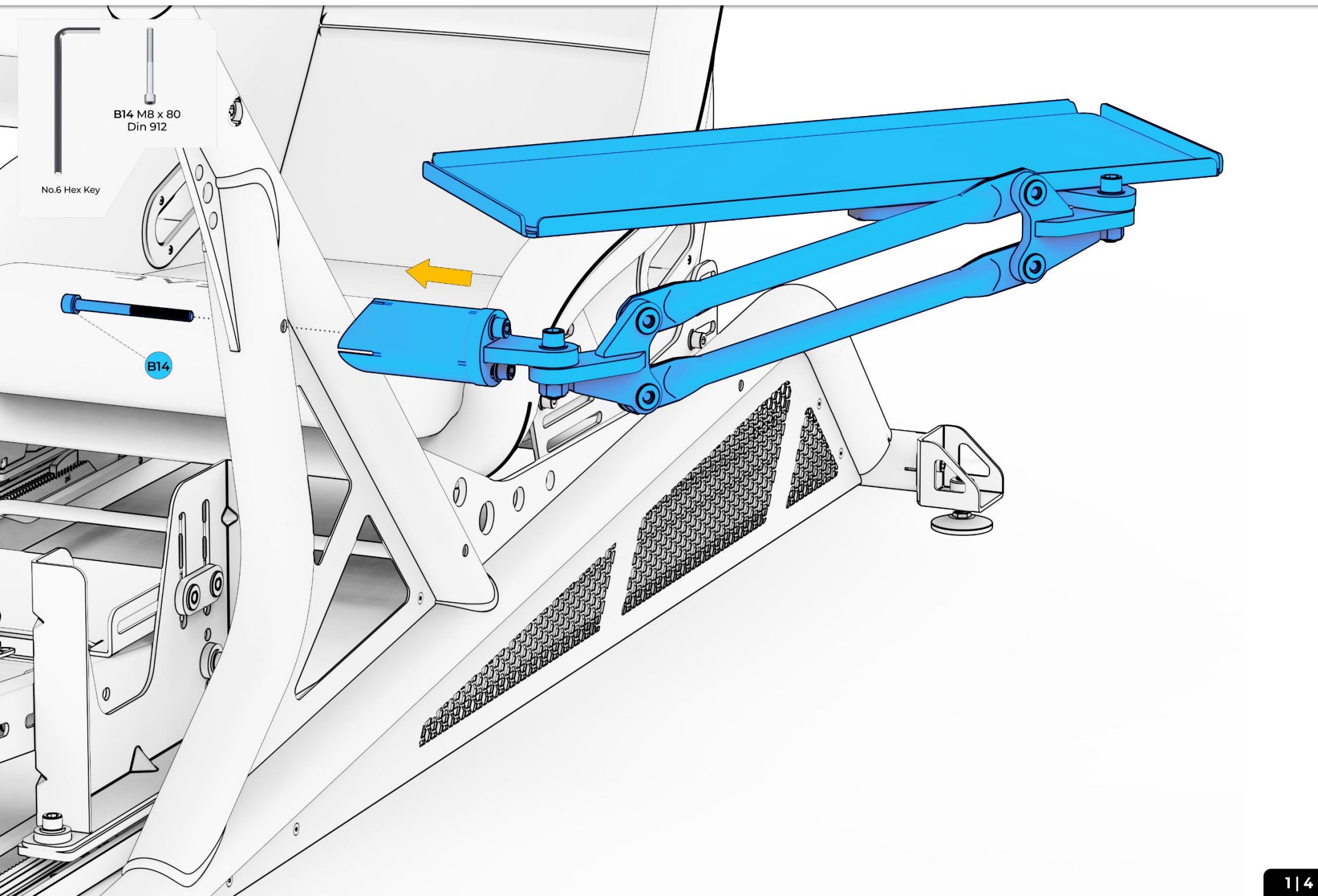

EVO KEYBOARD TRAY - RIGHT-SIDE INSTALLATION ASSEMBLY

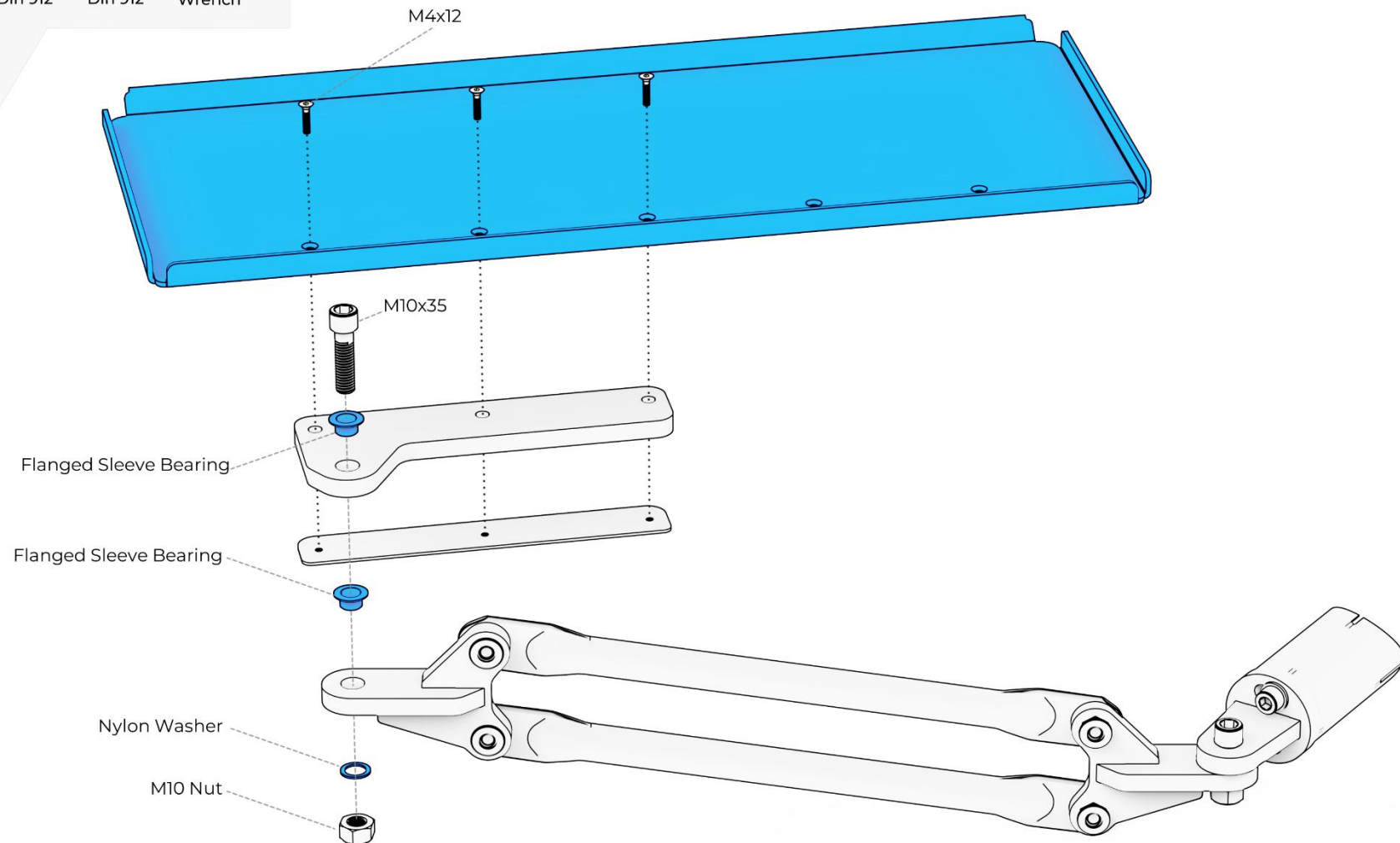

NOTE! The keyboard tray comes preassembled for left-side chassis installation. Please proceed with the above installation to invert it to the right-side chassis installation configuration.

EVO KEYBOARD TRAY - RIGHT SIDE INSTALLATION



B14 M8 x 80
Din 912

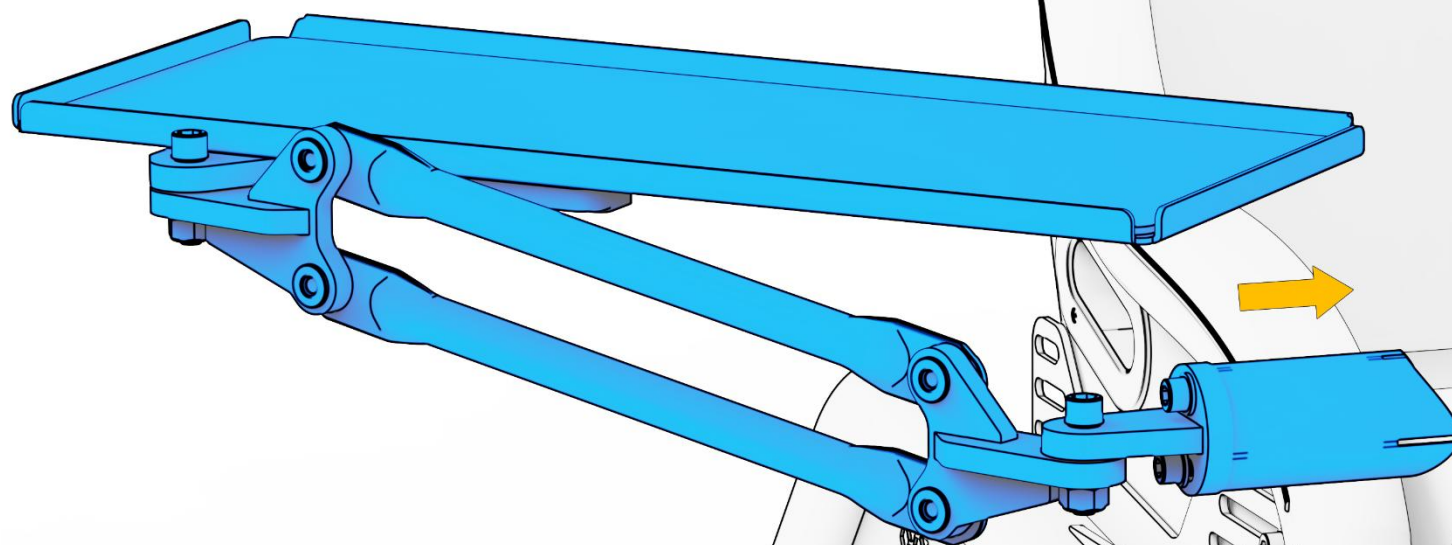

B14



No.6 Hex Key

Adjust the tilt so that the tray is parallel to the floor.

ADJUST HEIGHT (No.6 Hex Key)

