**⚠ WARNINGS**

Before assembling this sim racing cockpit, please read all installation instructions and warnings thoroughly.

FAILURE TO COMPLY WITH ALL ASSEMBLY, SAFETY, AND OPERATION INSTRUCTIONS AND WARNINGS WHEN USING THIS PRODUCT MAY RESULT IN SERIOUS INJURY.

This sim racing cockpit meets all safety regulations. Improper use may result in injury to individuals and damage to the chassis.

RSEAT EVO**INSTRUCTION MANUAL**

revision 01 / 12.2025

SX57 MONITOR STAND

EVO SX57 MONITOR STAND - LEFT AND RIGHT UPRIGHTS INSALLATION

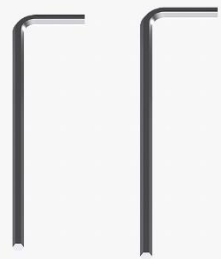

No.5 Hex Key No.6 Hex Key



B15 M8x25
DIN 912 B19 M10x35
DIN 912

First, install the left and right uprights (**Step 1**). Do not tighten them to the chassis yet; this will allow for free movement from left to right, ensuring proper alignment for the next step. Next, proceed to **Step 2** to install the horizontal support. Once everything is in place, tighten all the bolts to secure the structure. You can adjust the stand to be closer to or further away from the wheelbase.

RIGHT-SIDE
(Pre-assembled at the Factory)

Care orientation!

LEFT-SIDE
(Pre-assembled at the Factory)

Step 1

Step 2

B19

B19

B15

B15

EVO SX57 MONITOR STAND - CENTRAL SUPPORT INSALLATION



No.6 Hex Key



B15 M8x25
DIN 912



SN T-Nut M8

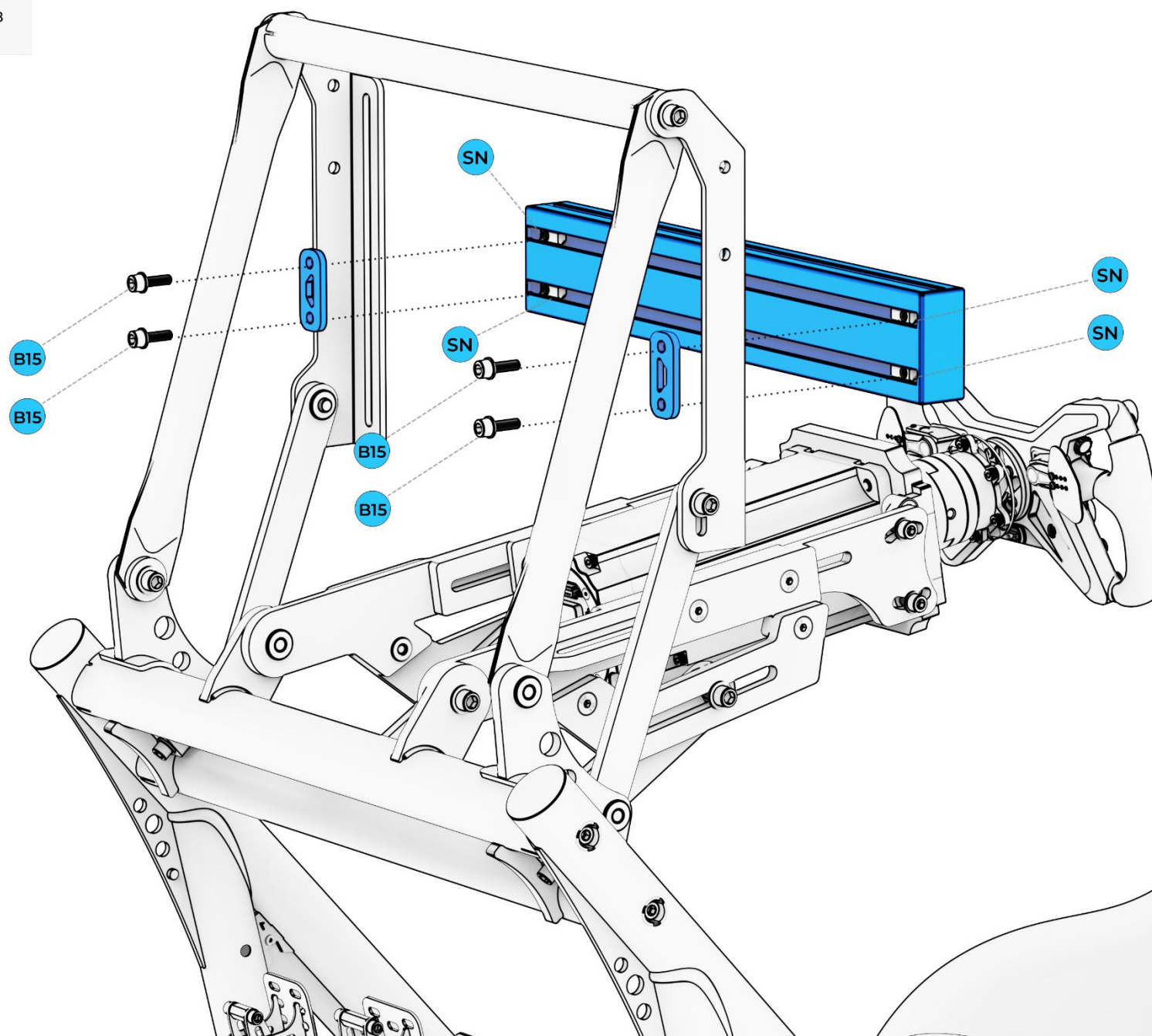



No.6 Hex Key



B4 M8x16
DIN 912



SN T-Nut M8

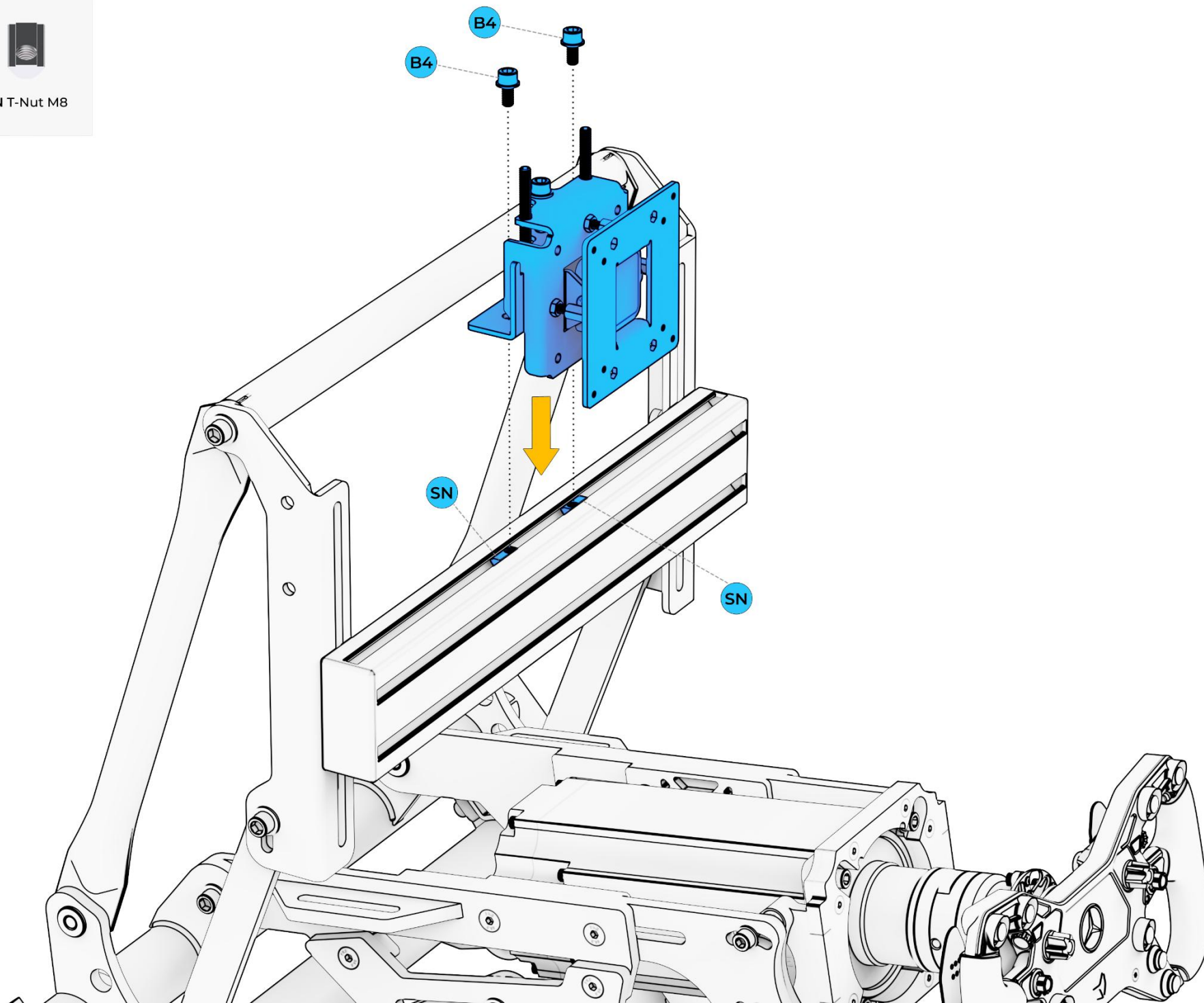

EVO SX57 MONITOR STAND - VESA MOUNT TO MONITOR INSALLATION

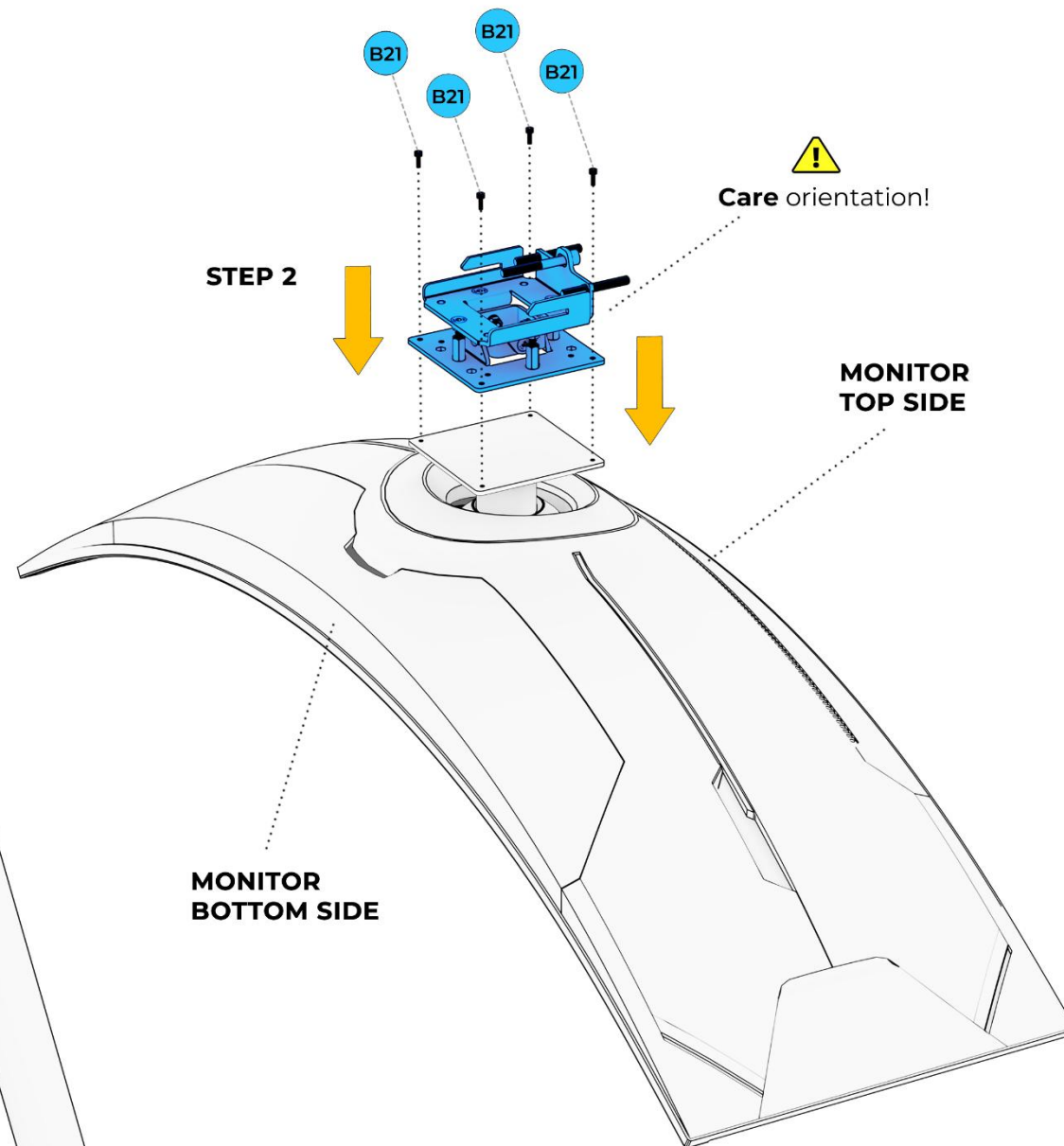
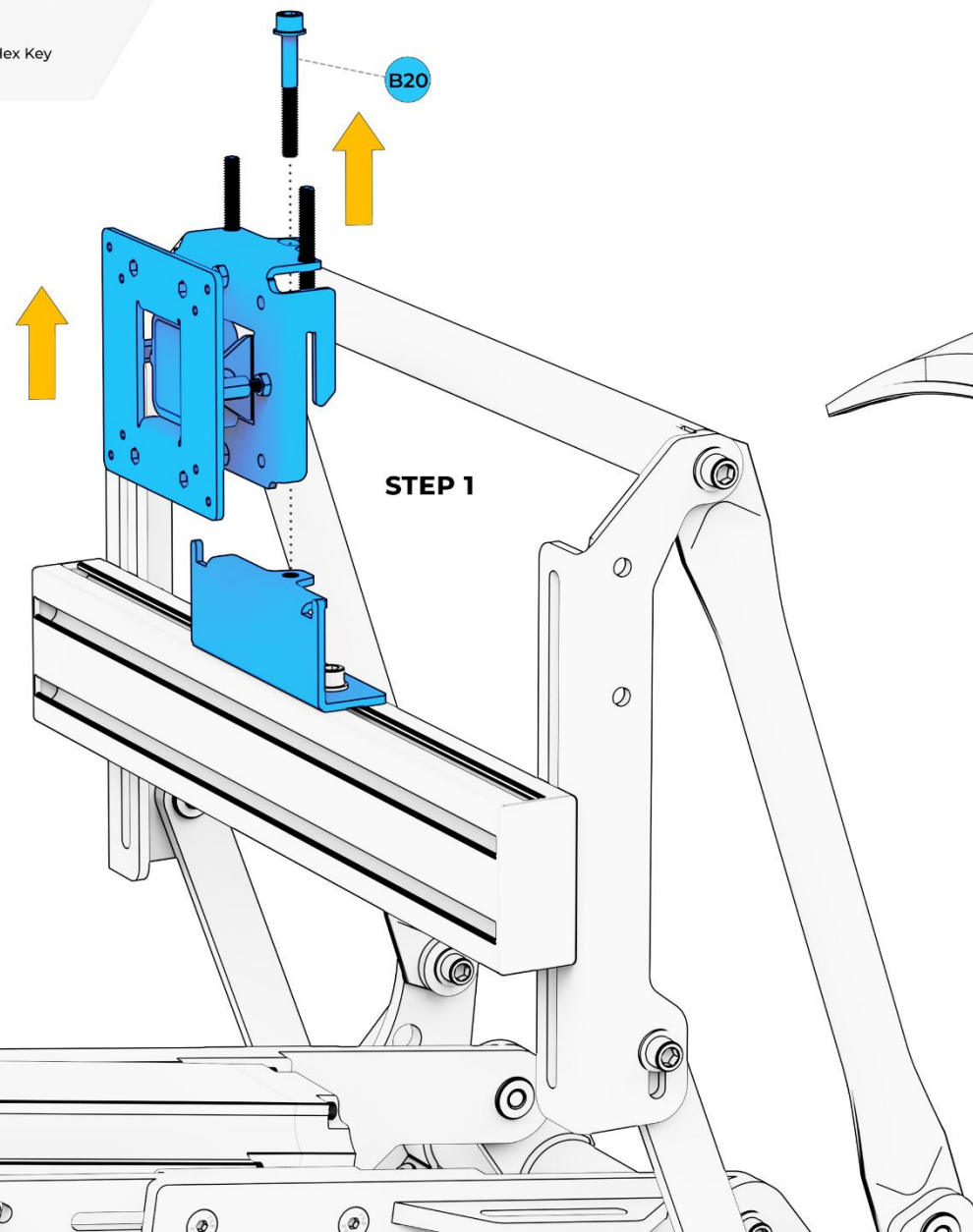
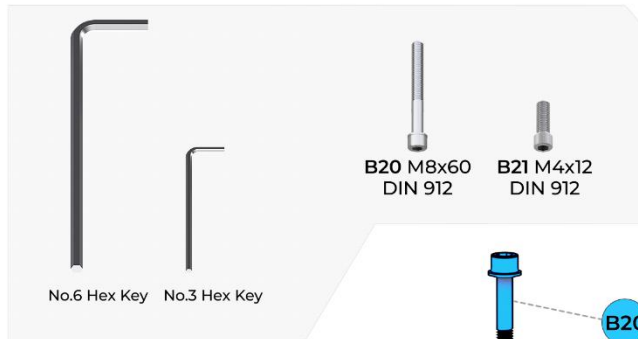



No.6 Hex Key



B20 M8x60
DIN 912

