**⚠ WARNINGS**

Before assembling this sim racing cockpit, please read all installation instructions and warnings thoroughly.

**FAILURE TO COMPLY WITH ALL ASSEMBLY, SAFETY, AND OPERATION INSTRUCTIONS AND WARNINGS WHEN USING THIS PRODUCT MAY RESULT IN SERIOUS INJURY.**

This sim racing cockpit meets all safety regulations. Improper use may result in injury to individuals and damage to the chassis.

**RSEAT EVO****INSTRUCTION MANUAL**

revision 01 / 12.2025

**Tablet Mount**

# EVO TABLET MOUNT - ASSEMBLY



No.6 Hex Key



**B3** M8x20  
DIN 912



**N2** M8 NUT  
DIN 6923

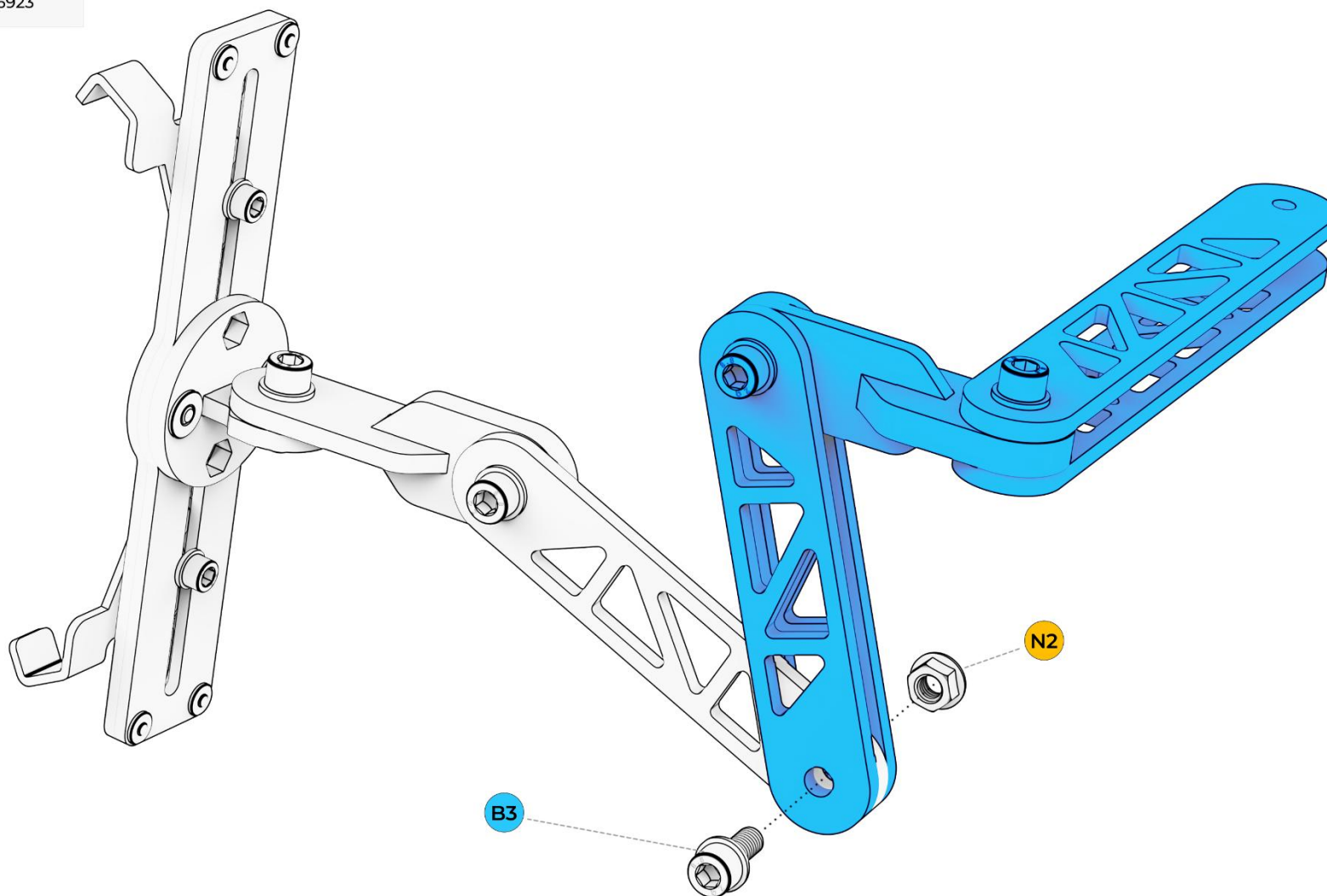

# EVO TABLET MOUNT - INSTALLATION ON LEFT/RIGHT SIDE OF CHASSIS



No.6 Hex Key



B15 M8x25  
DIN 912



N2 M8 NUT  
DIN 6923

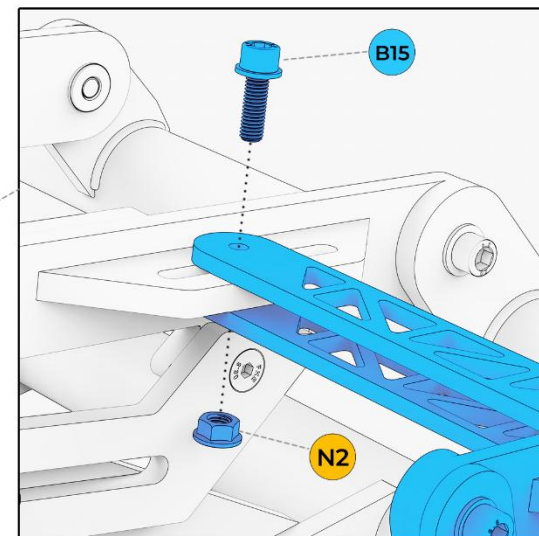
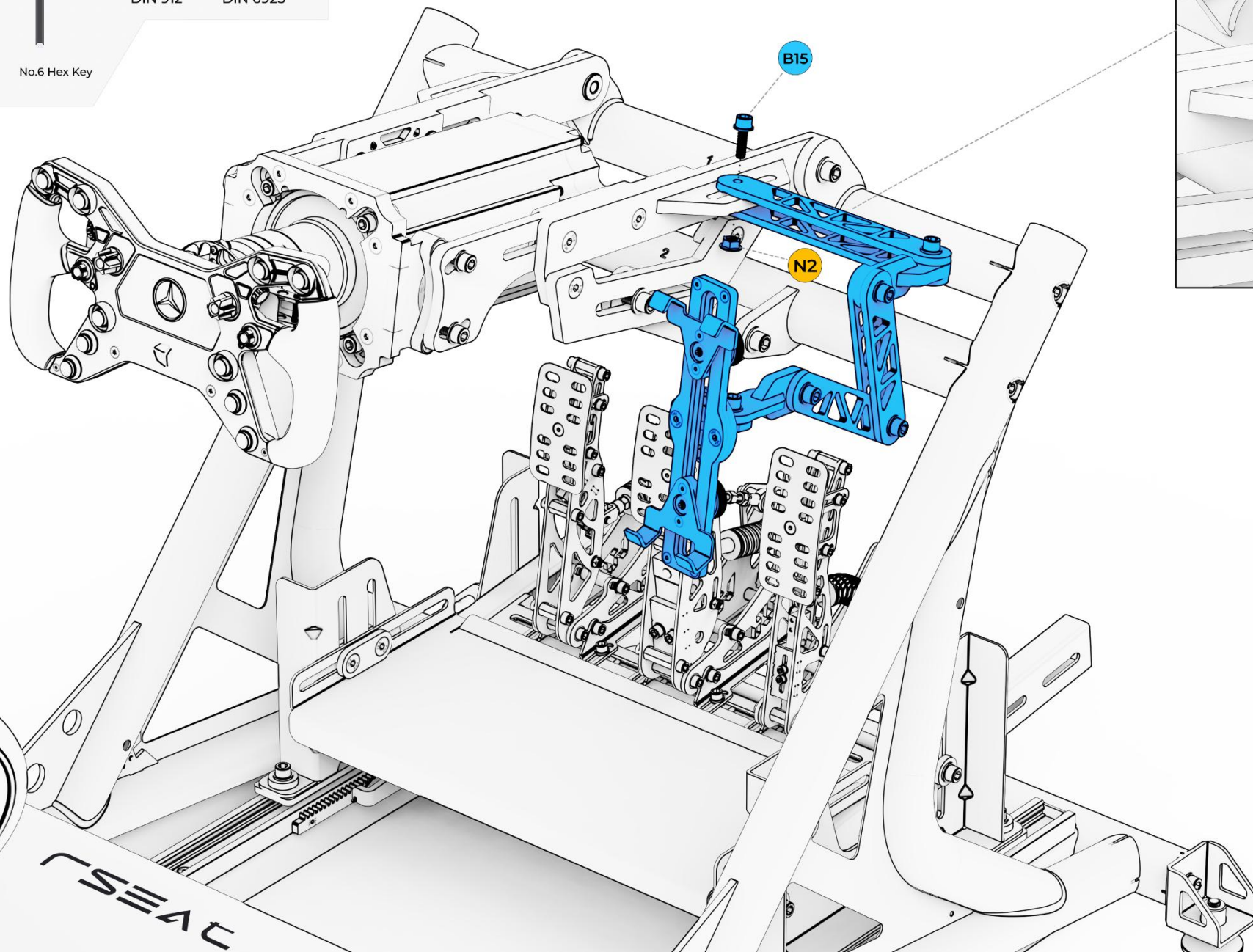



## EVO TABLET MOUNT - TABLET/PHONE INSTALLATION



No.5 Hex Key



B6 M6x16  
DIN 912

Install the tablet on the lower support bracket, then slide the top support bracket to secure the tablet or phone in place. Use a No. 5 Hex Key.

